

A (x1)

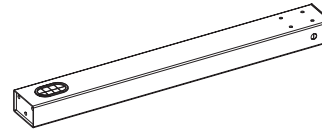

B (x1)

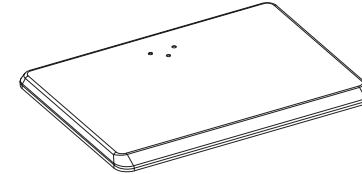

C (x1)



D (x1)

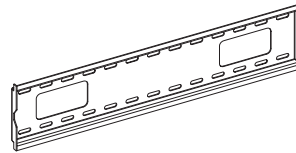

E (x1)

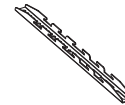

F (x2)



G (x2)



H (x2)



I (x2)



J (x4)  
M6



K (x4)  
D6  
Metal Washer



L (x4)  
D6  
Plastic Washer



M (x3)  
D8



N (x2)  
M5x10



O (x8)  
M6x16



P (x3)  
M8x20

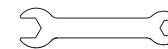

Q (x1)  
10-12mm



R (x1)  
4mm



S (x1)  
5mm



M-A (x4)  
M6x14



M-B (x4)  
M8x16



M-C (x4)  
M6x30

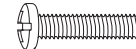

M-D (x4)  
M8x35



M-E (x4)  
D8



M-F (x4)  
Ø15xØ8x5



M-G (x4)  
Ø15xØ8x15

VESA Compatible  
200x200 300x200  
400x200 300x300  
400x300 400x400  
600x400

75"  
MAX  
FLAT/CURVED



50kg/110lbs



5kg/11lbs

1

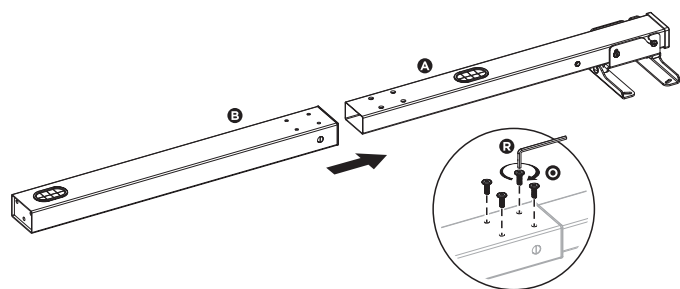

2

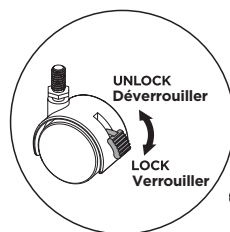

Lock the brakes on the casters to avoid any sudden movements during installation.  
Verrouiller les freins des roulettes pour éviter tout mouvement lors de l'installation.

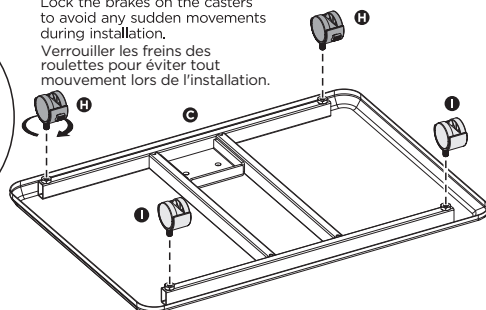

3

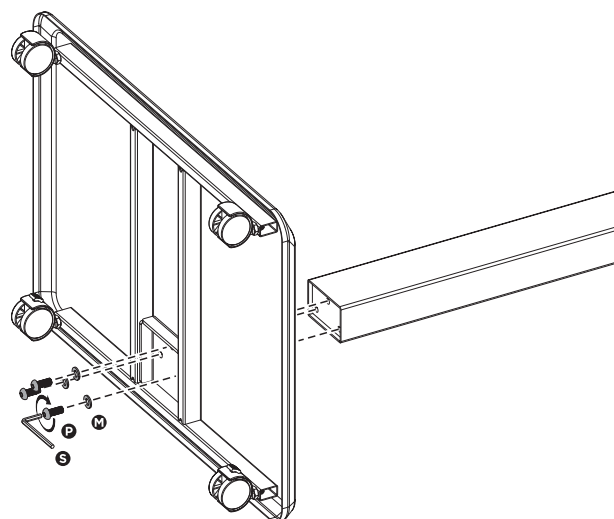

4

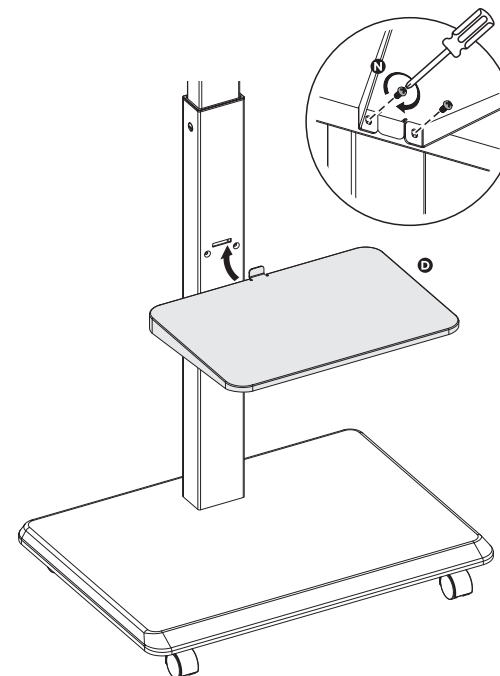

5

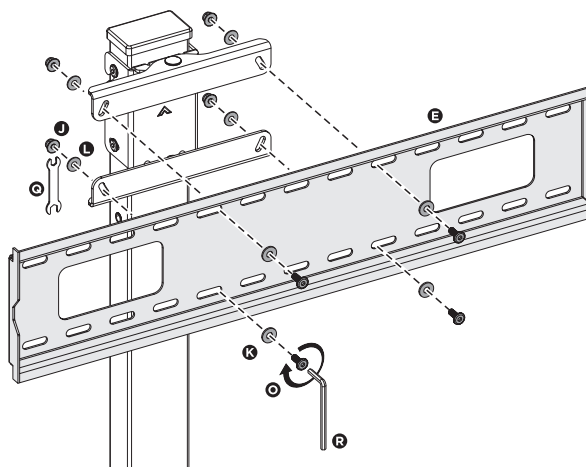
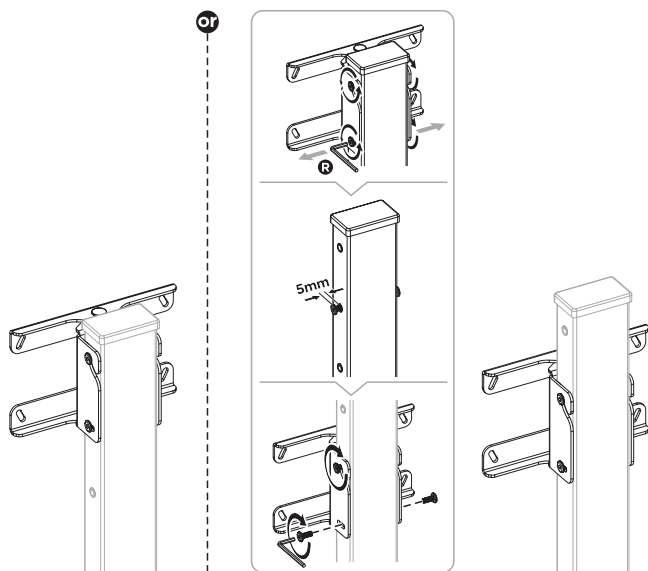

6

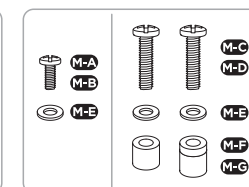
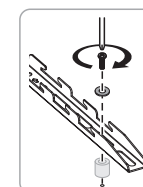
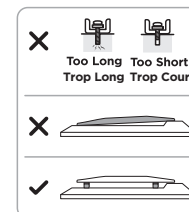
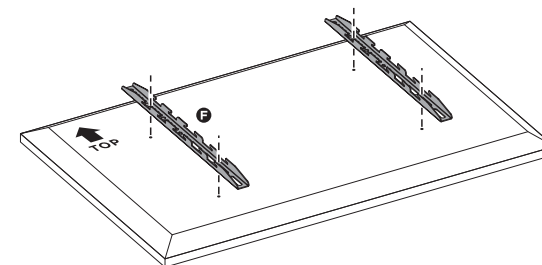

7

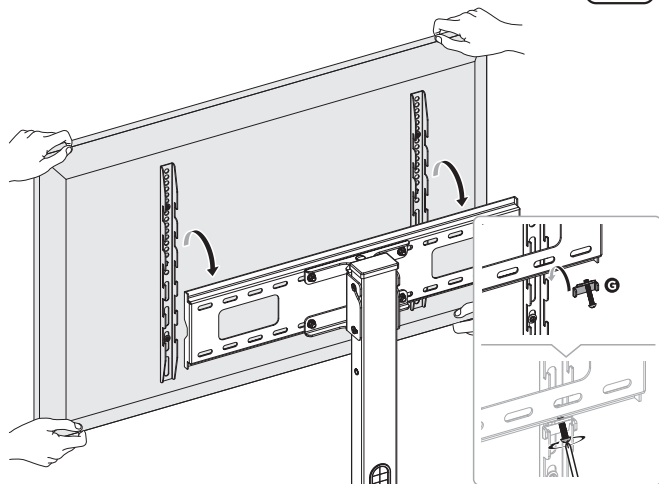

8

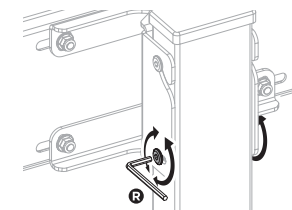
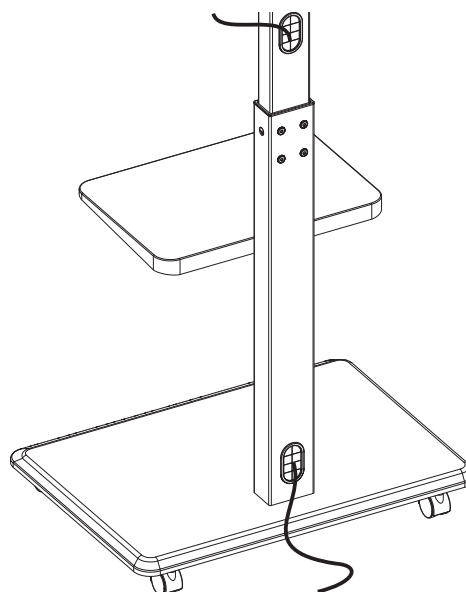

**Note:** If the display does not stop at your desired position, adjust the two side screws alternately using the tools as shown.

si l'écran ne s'arrête pas à la position souhaitée, régler les deux vis latérales alternativement à l'aide des outils comme indiqué.

